



Fairmead, Yarm, TS15 9QP

Located on the ever popular Layfield Estate, this detached family home offers generous living space in a highly sought after part of Yarm. The property is ideally positioned within walking distance of Yarm High Street, which has a fantastic selection of independent cafés, restaurants, bars, and shops. It's also within catchment for highly regarded primary and secondary schools, making it an ideal family home. While the property would benefit from a degree of updating, it presents an excellent opportunity for buyers to put their own stamp on a home in a prime location.

The accommodation is gas centrally heated, features a Hive smart system, and benefits from double glazing and leased solar panels for enhanced energy efficiency. The entrance hallway includes a large bow window and a spacious storage cupboard, leading into a kitchen/breakfast room with fitted units and a breakfast bar. The lounge flows through to the dining area with French doors that open onto the rear garden, creating a bright and versatile living space. From the kitchen, a rear hall gives access to a utility room and the integral garage.

Upstairs, the property offers four well proportioned bedrooms and a large family bathroom with both a separate bath and shower. Outside, the rear garden is mostly laid to lawn and enjoys a good level of privacy, while the front offers lawn and driveway parking to the side of the garage.

With no onward chain, this property presents a superb opportunity for buyers seeking a spacious, well-located home in Yarm.

We have been advised that the garage floor needs replacing.

£220,000



4



1



1



Fairmead, Yarm, TS15 9QP

HALL

KITCHEN

21'7" x 8'5" (6.58m x 2.57m)

LOUNGE

15'10" x 13'1" (4.83m x 3.99m)

DINING ROOM

14'1" x 9'8" (4.29m x 2.95m)

INNER HALL

UTILITY

8'5" x 6' (2.57m x 1.83m)

LANDING

BEDROOM ONE

11'5" x 10'6" (3.48m x 3.20m)

BEDROOM TWO

10'1" x 9' (3.07m x 2.74m)

BEDROOM THREE

9'8" x 8'7" (2.95m x 2.62m)

BEDROOM FOUR

7'2" x 6'6" (2.18m x 1.98m)

BATHROOM

11'6" x 9'3" (3.51m x 2.82m)

AML PROCEDURE

To comply with anti-money laundering regulations (AML) all estate agents must be registered with HMRC. Gowland White complies with this legislation by using an online AML risk assessment company, approved by the UK Government. Please note that all buyers are charged a fee of £36.00 (inc. VAT), for each buyer, to cover this process. These fees are payable before we can progress an agreed sale.







Fairmead, Yarm, TS15 9QP

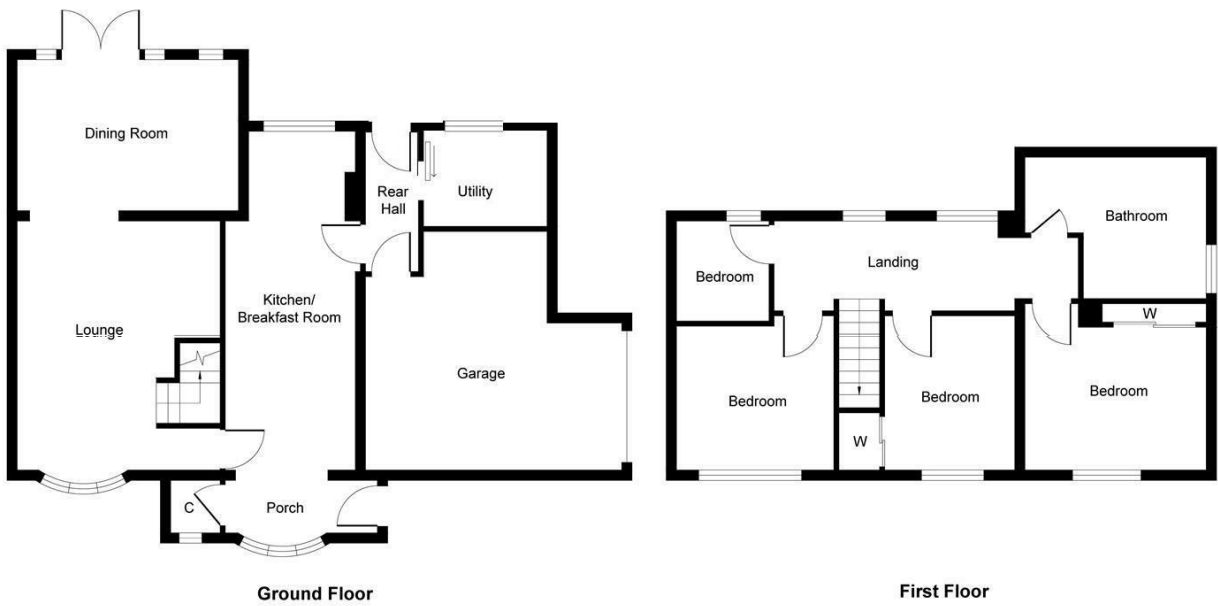

Whilst every attempt has been made to ensure the accuracy of the floor plan contained here, measurements of doors, windows, rooms and any other items are approximate and no responsibility is taken for any error, omission, or mis-statement. The measurements should not be relied upon for valuation, transaction and/or funding purposes. This plan is for illustrative purposes only and should be used as such by any prospective purchaser or tenant. The services, systems and appliances shown have not been tested and no guarantee as to their operability or efficiency can be given.

Copyright V360 Ltd 2025 | www.houseviz.com

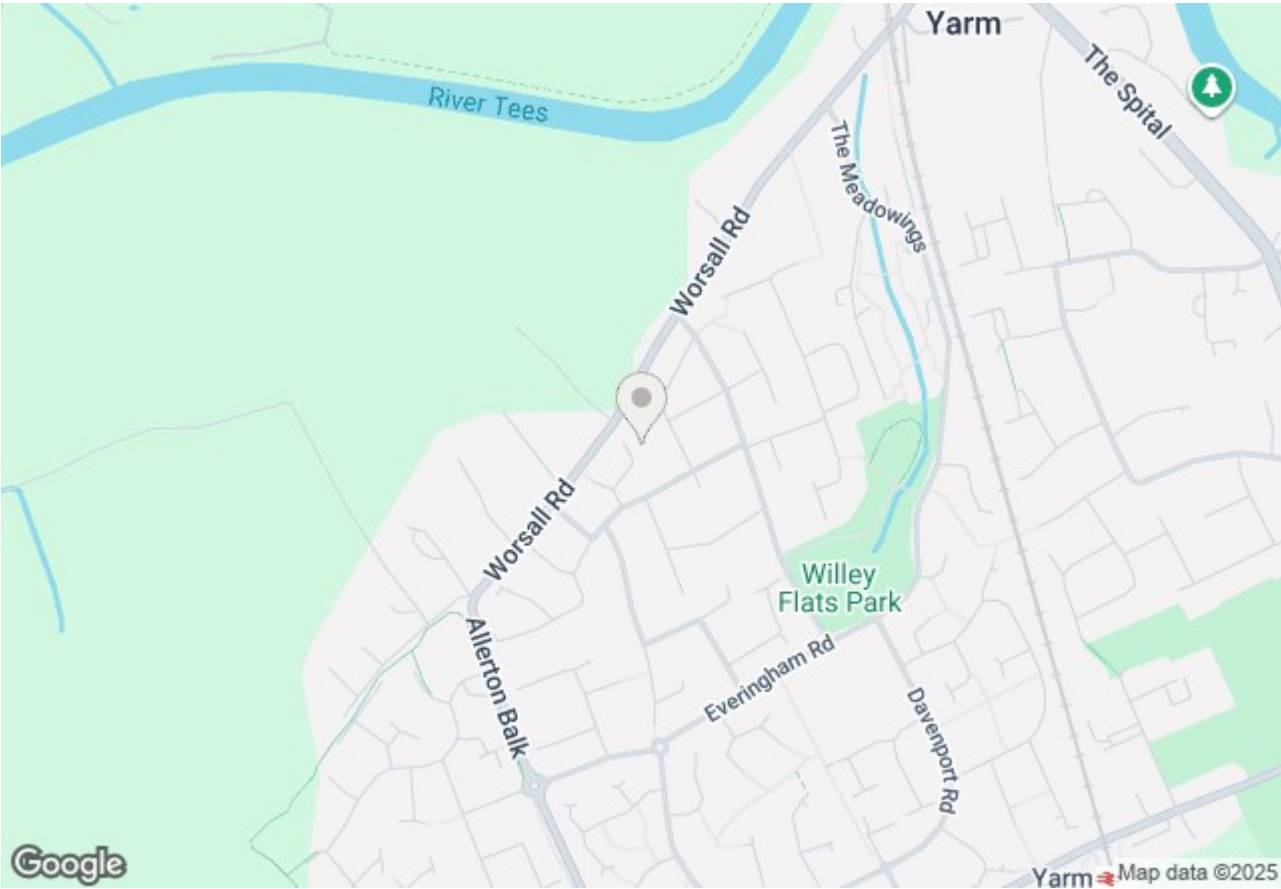

Fairmead, Yarm, TS15 9QP

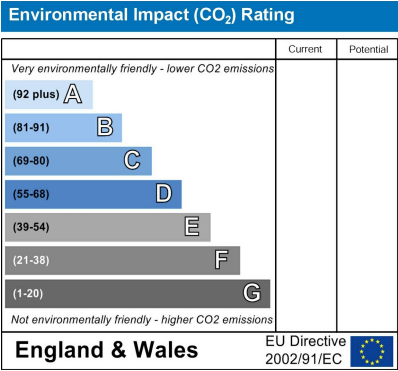
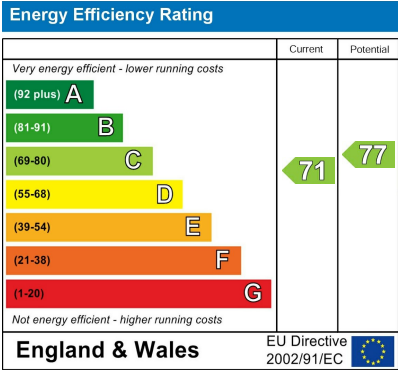

VIEWING

Please contact us on 01642 248248 if you wish to arrange a viewing or would like more information.

These particulars, whilst believed to be accurate are set out as a general outline only for guidance and do not constitute any part of an offer or contract. Intending purchasers should not rely on them as statements of representation of fact, but must satisfy themselves by inspection or otherwise as to their accuracy. No person in this firms employment has the authority to make or give any representation or warranty in respect of the property.

101 High Street, Yarm, TS15 9BB
yarm@gowlandwhite.co.uk